

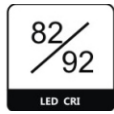

ION-K3023-XC

MULTIPLE HEADS LED COB TRACK LIGHT WITH FIXED TRACK BAR

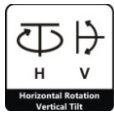

Project Name:	
Catalog #:	
Fixture Type:	
Notes:	

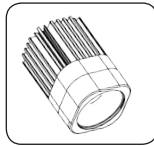

NEW PRODUCTS COMING SOON



DESCRIPTION

Color Temperature 2700K-6000K
 CRI 82/92
 3 Step MacAdam (3 SDMC)
 Passive aluminum heat sink
 50,000 hrs average rated life

DIMMING

Track Dimming: (ELV) reverse phase control dimmers. 120V only.
 Dimmable 100 – 10%
 Canopy Dimming: ELV Dimming 120V
 0-10V Dimming 120V or 277V

DRIVER

Track luminaire is designed for use with the following track systems

- Single Circuit/Single Neutral 120V
- Two Circuit/Single Neutral 120V (No Dimming)
- Two Circuit / Two Neutral 120V
- Two Circuit / Two Neutral 277V

OPTICS

16° Spot, 24° Narrow Flood, 32° Flood, 50° Wide Flood

COB 30W = Halogen 150W

Mounts to a standard 4" square or octagon junction box.

LISTING / WARRANTY

ETL listed to US and Canadian standards for damp location W/Feed through.
 5 Years Limited Warranty.



DIMENSIONS

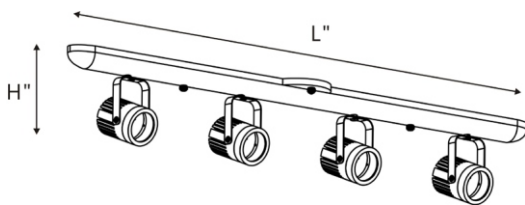

Lamp	1-Lamp	2-Lamp	3-Lamp	4-Lamp
Length (L)	4 15/16"	17 11/16"	25 3/16"	36"
Height (H)	6"	6"	6"	6"

AVAILABLE FOR MULTIPLE MOUNTING STYLES

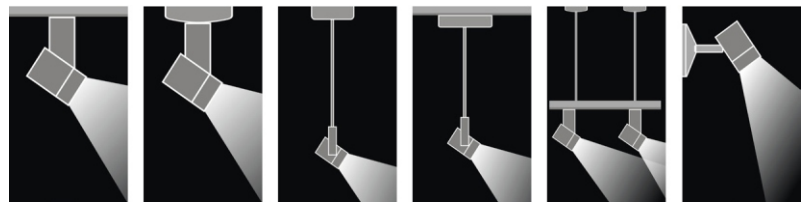

- a - Track Mount
- b - Canopy Mount
- c - Canopy+Suspended Mount
- d - Track+Suspended Mount
- e - Canopy+Suspended+Track Mount
- f - Wall Mount

ORDERING GUIDE/OUR PRODUCT CODE

SERIES	BEAM SPREAD	BEAM SPREAD	POWER SUPPLY	CCT	LED AVAILABLE	FINISH
○ K3023-1C	○ 15W/Lamp	○ 16° Spot	○ Non-Dimming 120V	○ 2700K	○ Philips	○ White
○ K3023-2C	○ 25W/Lamp	○ 24° Narrow Flood	○ Non-Dimming 277V	○ 3000K	○ Cree	○ Black
○ K3023-3C	○ 30W/Lamp	○ 32° Flood	○ 0-10V Dimming 120V	○ 4000K	○ Epistar	○ Silver
○ K3023-4C		○ 50° Wide Flood	○ 0-10V Dimming 277V	○ 5000K	○ Seoul	○ Satin Nickel
				○ 6000K	○ Osram	

Customized Also Available